

# Mercy Medical Center

## FIRST FLOOR

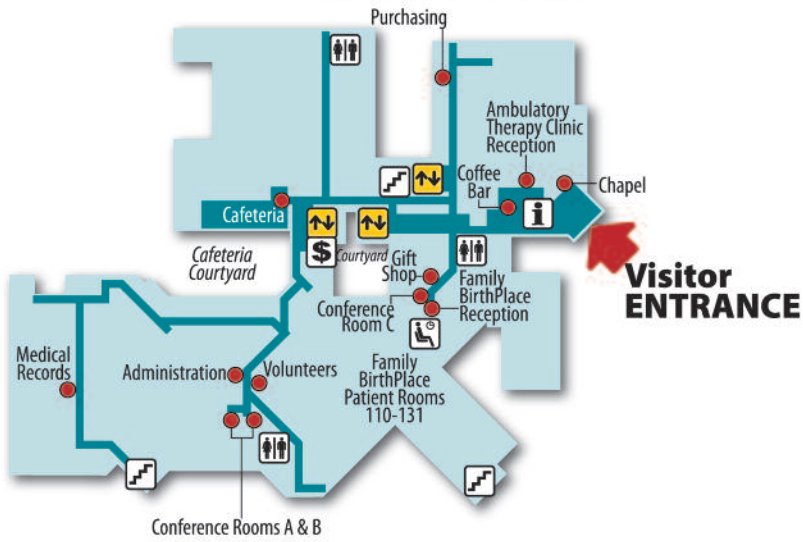

## ORegon Surgery Center ENTRANCE

## Emergency ENTRANCE

## Patient ENTRANCE

Elevator to Physician Offices

## SECOND FLOOR

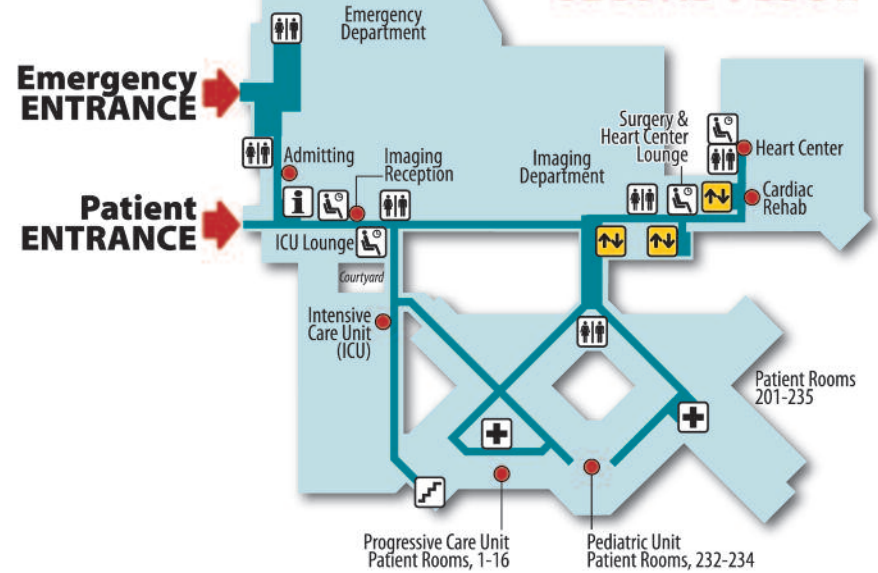

## THIRD FLOOR

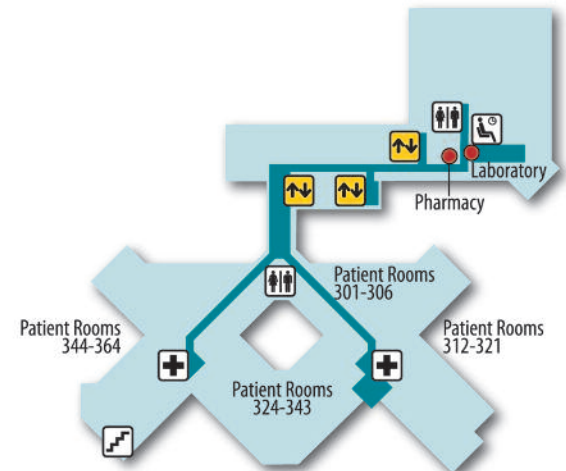

### map key

- Information
- Elevator
- Stairs
- Lounge
- Restrooms
- Nurse Station
- ATM

### department listing

Administration.....	1
Admitting .....	2
Ambulatory Therapy Clinic Reception.....	1
Cafeteria.....	1
Cardiac Rehab .....	2
Chapel.....	1
Coffee Bar .....	1
Conference Rooms A, B, C .....	1
Emergency Department.....	2
Family BirthPlace, Patient Rooms 110-131.....	1
Family BirthPlace Reception .....	1
Gift Shop .....	1
Heart Center.....	2

### floor

### department listing

Imaging Department .....	2
Imaging Reception.....	2
Intensive Care Unit (ICU) .....	2
Laboratory.....	3
Medical Records .....	1
ORegon Surgery Center Reception .....	2
Patient Rooms, 201-235 .....	2
Patient Rooms 301-364.....	3
Pediatric Unit, Patient Rooms 232-234 .....	2
Pharmacy.....	3
Progressive Care Unit, Patient Rooms 1-16 .....	2
Purchasing .....	1
Volunteers.....	1

### floor

# Mercy Medical Center

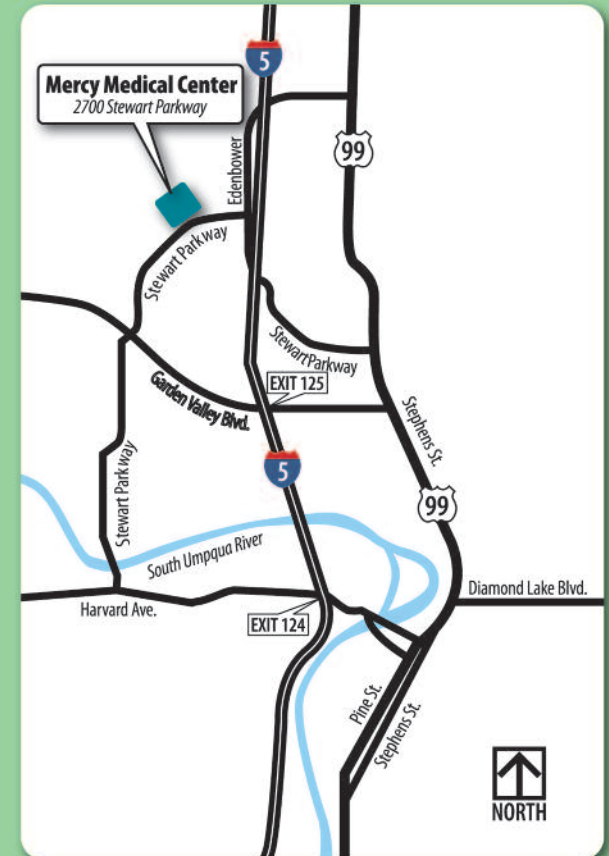

2700 Stewart Parkway • Roseburg, Oregon 97471  
(541) 673-0611 • [www.mercyrore.org](http://www.mercyrore.org)